

Project	
Date	
Prepared By	
Model#	

Specifications

ELECTRICAL

Input Voltage:

DC12V \pm 1V

Input Current:

40mA

Standby Power:

<0.8W

Sinking Current:

\leq 10mA

Detection Range:

45ft Max

Mounting Height:

20ft Max

IR Remote Distance:

Max 20'

IP Rating: IP20

Operating Temperature:

-40°C to 40°C, -40°F to 104°F

AGENCY APPROVALS UL:

UL8750

FCC: Yes

RoHS: Yes

PRODUCT DETAILS

Product Color: White

Warranty: 5 Years

12VDC Microwave Sensor For Strip/Vapor Fixtures

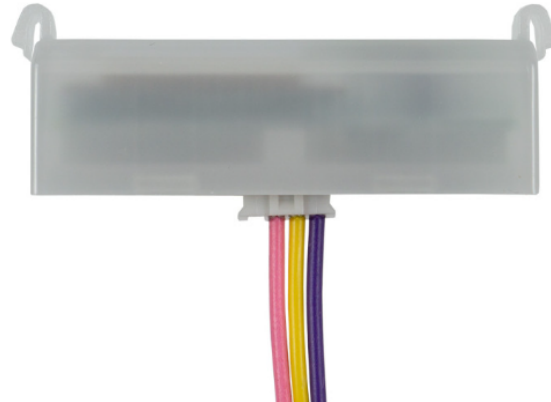

ORDER CODE: 11847

INPUT VOLTAGE
DC12V \pm 1V

PRODUCT DESCRIPTION

EarthTronics Strip/Vapor 12VDC Microwave Sensor is a compact microwave sensor that combines occupancy sensing with a photocell. When used with 0-10V dim-to-off LED drivers, it can be easily added to luminaires.

DIMENSIONS

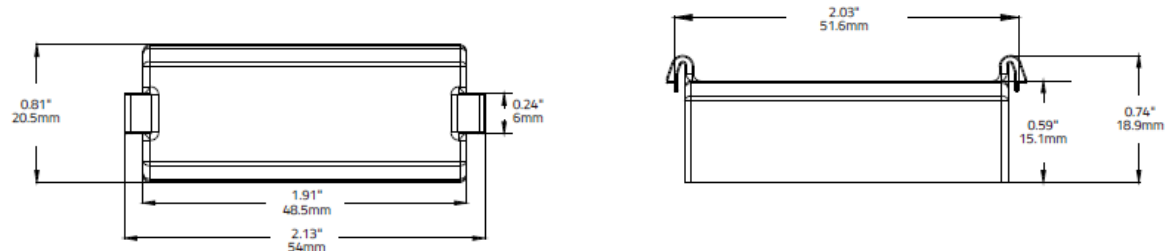

WIRING

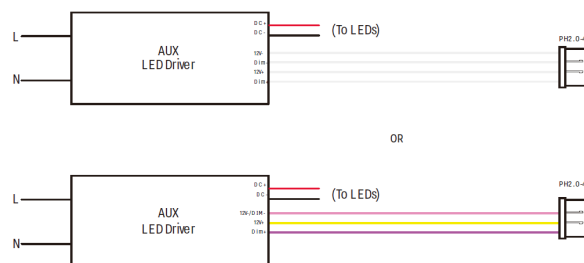

COVERAGE

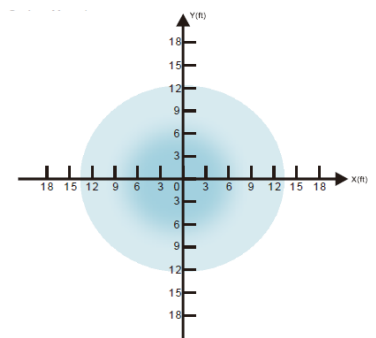

SENSOR REMOTE SOLD SEPERATELY -

Please consult installation instructions for proper application and use of this fixture.