

Project	
Date	
Prepared By	
Model #	DL8WSCCTWH1

## Specifications

### ELECTRICAL

**Watts:** 10, 15, or 24  
**Voltage:** 120-277VAC  
**Dimming:** 0-10V  
**Power Factor:** 0.97  
**Operating Temp.:**  
 -40°F - 135°F

### LIGHT

**Lumens:**  
 1000, 1500 or 2400  
**Color Temperature:**  
 2700K, 3000K, 3500K,  
 4000K, 5000K  
**CRI:** >90

### AGENCY APPROVALS

**UL / cUL:** Yes  
**Wet Location:** Yes  
**California:** JA8, Title 24  
**Energy Star:** Yes

### MATERIALS

**Driver Housing:**  
 Cast Aluminum  
**Fixture Body:**  
 Spun Aluminum  
**Lens:**  
 Optical polycarbonate

### RATED LIFE

**Warranty:** 5 years  
**Life:**  
 50,000 hours L80

## 8" Commercial Downlight LED Fixture

### Color and Wattage Selectable

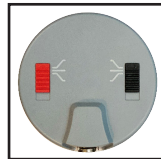

### ORDER CODE:

11419

### MODEL NUMBER:

DL8WSCCTWH1

### COLOR SELECTABLE:

2700K, 3000K, 3500K,  
4000K, 5000K

### LUMEN LEVEL:

1000 lumens - 10 watts  
 1500 lumens - 15 watts  
 2400 lumens - 24 watts

### ENERGY STAR ID:

3891887

REBATE AVAILABILITY\*

## PRODUCT DESCRIPTION

The EarthTronics LED architectural grade downlight fixture provides the flexibility to insure the correct light level and color temperature desired in different applications. Select from 2700K, 3000K, 3500K, 4000K or 5000K color temperatures as well as 1000, 1500 or 2400 lumen levels with a switch located on the driver housing. The fixture features a matte-white finish, frosted lens and a deep parabolic design which provides an ample cut-off angle. This 8" fixture can be used in new construction or in retrofit/renovation applications. The durable corrosion resistant stainless-steel spring clips accommodate up to 2" thick ceilings. The driver operates on 120-277VAC and is complete with 0 - 10 volt dimming. The die-cast driver housing and high quality LED chips provide 50,000 hour rated life at L80. Five year warranty. Meets strict California JA8 standards and is Title 24 compliant. IC Rated for use in insulated ceiling applications and meets IECC air leakage requirements. Maybe be installed in wet locations such as soffit and covered walkway installations, out of direct weather.

## PRODUCT FEATURES

- + Color selectable: 2700K, 3000K, 3500K, 4000K, 5000K
- + 90+ CRI enhanced color clarity
- + Easy Installation
- + 0-10 volt dimming, 120-277VAC
- + 50,000 hour rated life
- + Replace 50 to 70 watt HID downlight cans
- + JA8, Title 24, IC Rated, meets IECC requirements, Energy Star Rated
- + Durable Aluminum Housing with spring-loaded retention clips

\*Wet location rated, not for use in direct weather applications.

## APPLICATIONS

- + Commercial buildings
- + Mezzanine level downlights
- + Wet location rated
- + Mezzanine level downlights

Please consult installation instructions for proper application and use of this fixture.

\*Rebate availability access it here: [www.earthtronics.com/rebate-finder](http://www.earthtronics.com/rebate-finder)

## PACKAGE DETAILS

### INDIVIDUAL PACKAGE

Individual Carton Qty: 1

Dimensions:

10.43" Length x 10.43" Width x 6.41" Depth

Weight: 2.27 LBS

UPC: 840791114193

### MASTER CARTON

Master Carton Qty: 4

Dimensions:

21.57" Length x 11.02" Width x 14.09" Height

Weight: 10.54 LBS

UPC: 84079111419300

## PRODUCT DIMENSIONS

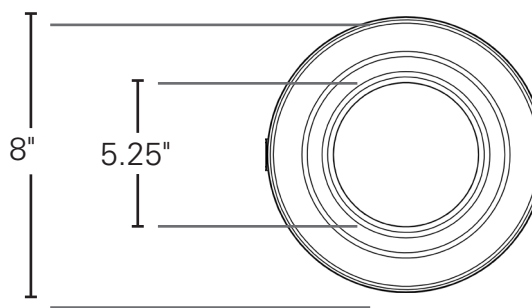
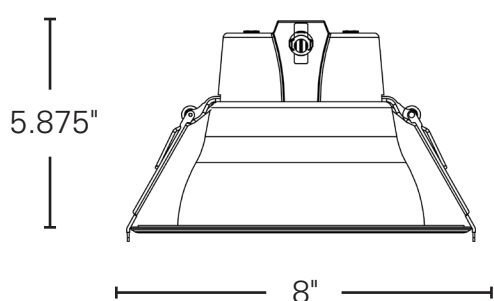

## OPTIONAL ACCESSORIES

### Goof Ring

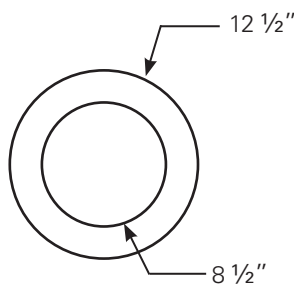

Order Code: 11424

### T-Grid Plate

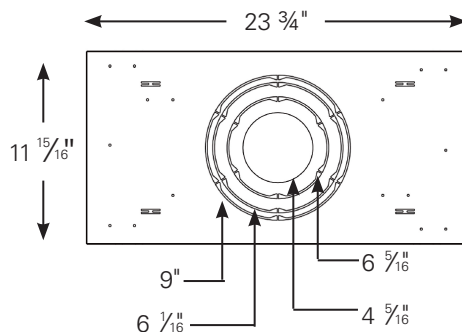

Order Code: 11422

### Stud Joist

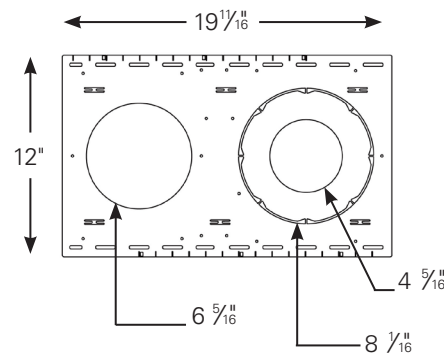

Order Code: 11421



Emergency Driver  
Order Code: 11501

Easily access our DLC qualified products with rebates in your area.

ACCESS IT HERE: [Rebate Finder - LED Commercial Downlights](#)

[www.earthtronics.com/rebate-finder/catalog/](http://www.earthtronics.com/rebate-finder/catalog/)

